

Feature :

- Small size
- Bi-color LED illuminated available
- Long electrical life cycles

Application :

- Consumer products
- Computer products
- Instrumentation
- Communication equipments



SWITCH SPECIFICATIONS	
POLE - POSITION	1P1T , with LED
CONTACT RATING	12 V DC , 50 mA
CONTACT RESISTANCE	100 mΩ MAX. 1.5 V DC ; 100 mA , by Method of Voltage DROP
INSULATION RESISTANCE	100 MΩ MIN. 500 V DC
DIELECTRIC STRENGTH	Breakdown is not Allowable ; 500 V AC for 1 Minute
OPERATING FORCE	180 ± 50 gf
OPERATING LIFE	500,000 cycles
OPERATING TEMPERATURE RANGE	-40°C ~ 85°C
TOTAL TRAVEL	0.2 ± 0.1 mm

LED SPECIFICATIONS								
ATTENTION LEDs are Electrostatic Sensitive devices 	Unit	Value / LED Color						
		Blue (5mA)	Pure Green	Red	Yellow	Orange	Green	White
LUMINOUS INTENSITY@20mA Iv	mcd	25	180	200	200	250	55	250
Dominant Wavelength λD	nm	470	525	630	590	601	567	/
FORWARD VOLTAGE@20mA Vf	V	2.8	3.2	1.95	2	2.1	2.1	4

■ A single bin cannot be ordered, please contact us in advance if you need a particular bin sorting before placing your order to clarify the lead time, MOQ and pricing

HOW TO ORDER

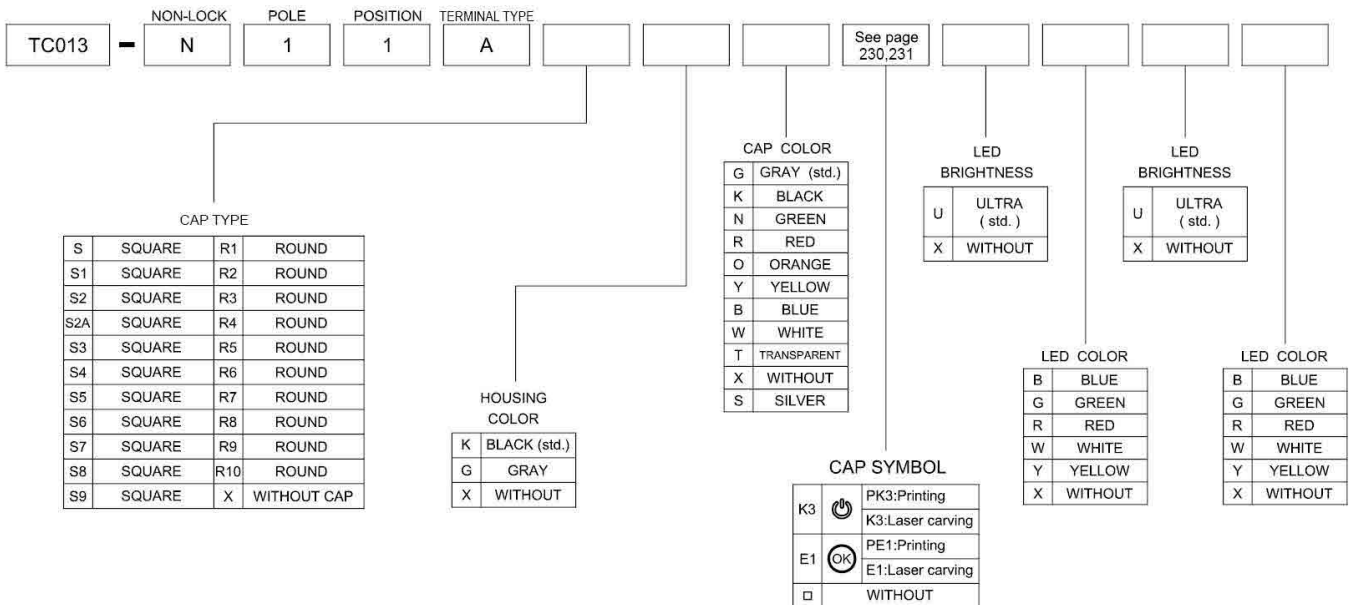

DIMENSION

• TC013-N11AXXX □□□□

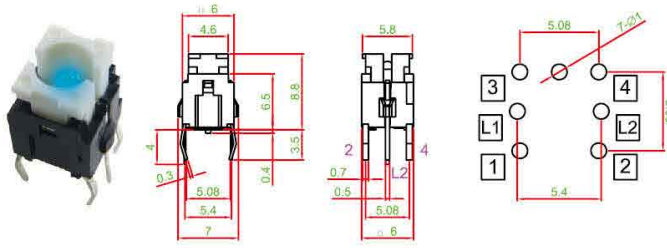

• TC013-N11AS1XX □□□□

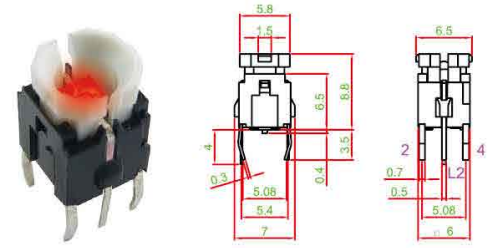

CAP TYPE(NO HOUSING / CAP ONLY)

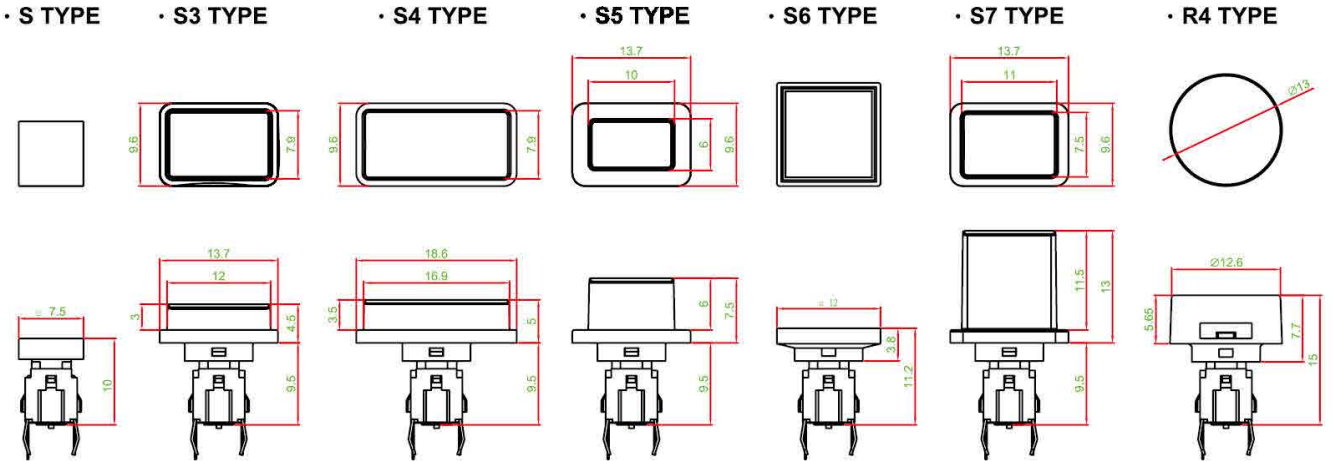

CAP WITH HOUSING

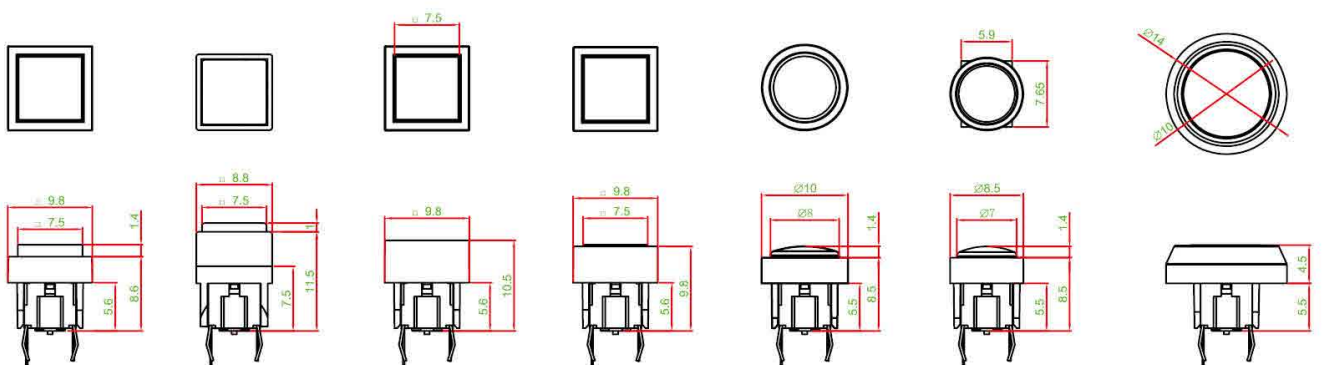

CAP WITH HOUSING



• R5 TYPE

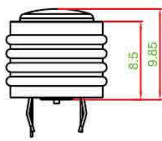
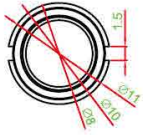

• R6 TYPE

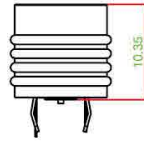
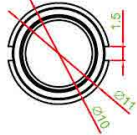

• R7 TYPE(ODM)

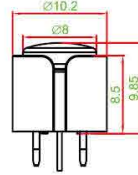

• R8 TYPE(ODM)

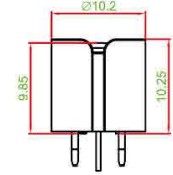
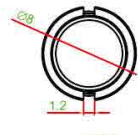

CAP WITH HOUSING(PANEL MOUNT)



• S8 TYPE

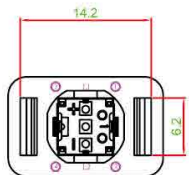
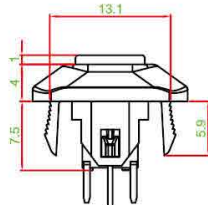
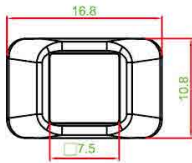

• S9 TYPE

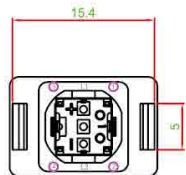
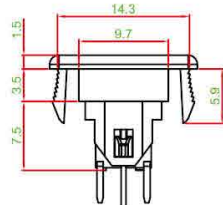
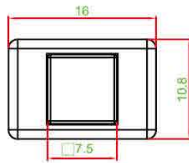

• R9 TYPE

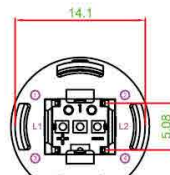
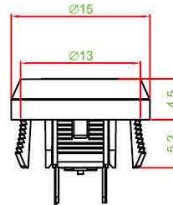
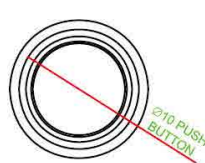

• R10 TYPE

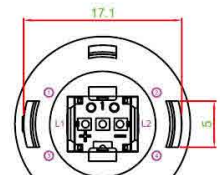
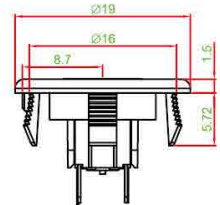
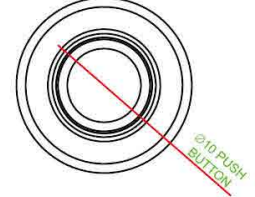

▶ PANEL CUT OUT	
PANEL THICK	W
0.75 ~ 1.25	13.2 ~ 13.3
1.25 ~ 2.0	13.3 ~ 13.4
2.0 ~ 3.0	13.4 ~ 13.5

▶ PANEL CUT OUT	
PANEL THICK	W
0.75 ~ 1.25	14.4 ~ 14.5
1.25 ~ 2.0	14.5 ~ 14.6
2.0 ~ 3.0	14.6 ~ 14.7

▶ PANEL CUT OUT	
Z	D
0 ~ 0.5	13.0 ~ 13.1
0.5 ~ 2.0	13.1 ~ 13.2
2.0 ~ 2.5	13.2 ~ 13.4
2.5 ~ 3.0	13.4 ~ 13.6
3.0 ~ 3.5	13.6 ~ 13.8

▶ PANEL CUT OUT	
Z	D
0 ~ 0.5	16.0 ~ 16.1
0.5 ~ 2.0	16.1 ~ 16.2
2.0 ~ 2.5	16.2 ~ 16.4
2.5 ~ 3.0	16.4 ~ 16.6
3.0 ~ 3.5	16.6 ~ 16.8

CIRCUIT

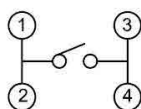

SINGLE COLOR

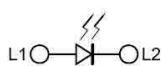

TWO COLOR

